

# FACILITY DETAILS

## SPECS & AMENITIES

### GRAND BALLROOM

- Dimensions: 93 ft. x 48 ft.
- Area: 4472 sq. ft.
- Sections: 3
- Banquet Capacity: 300
- Theater Capacity: 400
- 2 Patio Access Doors
- 4 Entrance Doors
- Surround Sound
- Thermostat

### EAST BALLROOM

- Dimensions: 58 ft. x 29 ft.
- Area: 1682 sq. ft.
- Sections: 2
- Banquet Capacity: 150
- Theater Capacity: 100
- 3 Entrance Doors
- 1 Adjacent Wall Entrance Door
- Surround Sound
- Thermostat

### GRAND BALLROOM – DIAMOND

- Dimensions: 29 ft. x 48 ft.
- Area: 1395 sq. ft.
- Banquet Capacity: 60
- Theater Capacity: 80
- 1 Patio Access Door
- 1 Entrance Door

### EAST BALLROOM - SAPPHIRE

- Dimensions: 27 ft. x 29 ft.
- Area: 783 sq. ft.
- Banquet Capacity: 60
- Theater Capacity: 50
- 1 Entrance Door
- 1 Adjacent Wall Entrance Door

### GRAND BALLROOM – OPAL

- Dimensions: 31 ft. x 48 ft.
- Area: 1480 sq. ft.
- Banquet Capacity: 60
- Theater Capacity: 80
- 2 Entrance Doors

### EAST BALLROOM - JADE

- Dimensions: 31 ft. x 29 ft.
- Area: 899 sq. ft.
- Banquet Capacity: 90
- Theater Capacity: 50
- 2 Entrance Doors

### GRAND BALLROOM – PEARL

- Dimensions: 33 ft. x 48 ft.
- Area: 1597 sq. ft.
- Banquet Capacity: 80
- Theater Capacity: 80
- 1 Patio Access Door
- 1 Entrance Door

### ALL ROOMS

- Dimmable Lighting

### COMMON AREAS

- Surround Sound
- Ambience Lighting
- Coat Closet

## ROOM COMPARISON CHART

ROOM	BANQUET CAP.	THEATER CAP.	AREA (SQ. FT.)
Grand Ballroom	300	400	4472
Diamond	60	80	1395
Opal	60	80	1480
Pearl	80	80	1597
East Ballroom	150	100	1682
Sapphire	60	50	783
Jade	90	50	899

**Graystone Event Center 6100 Sq. Ft.**

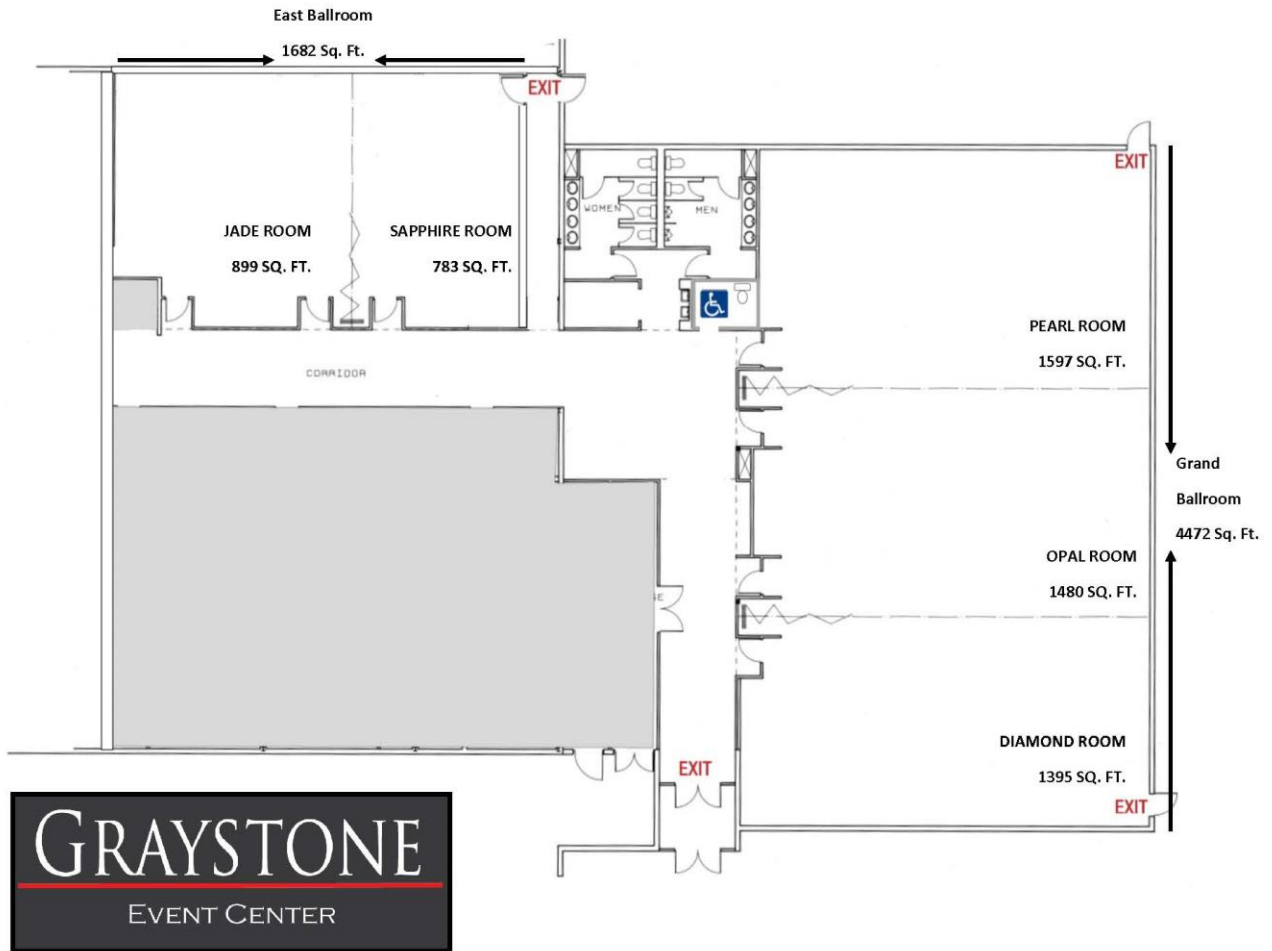

For questions and additional information contact the Sales Department. (231)845-7311  
 Graystone Event Center & Bryeten LLC · 4079 W. US-10, Ludington, MI 49431 · (231)845-7311